







BLU 60 mm

DESCRIPTION: Slab **TEXTURE:** Smooth and HD² Smooth



Specifications per pallet ¹		Imperial	Metric
A 	Product dimension (L x W x H) A	6 1/2 x 13 x 2 3/8	165 x 330 x 60
	Product dimension (L x W x H) B	13 x 13 x 2 3/8	330 x 330 x 60
	Product dimension (L x W x H) C	19 1/2 x 13 x 2 3/8	495 x 330 x 60
44 units / pallet			
B 	Cubing	116.82 ft ²	10.96 m ²
	Approx. Weight Smooth	3 170 lbs	1 438 kg
	Approx. Weight HD ² Smooth	3 295 lbs	1 495 kg
44 units / pallet			
C 	Number of rows	11	
	Coverage per row	10.62 ft ²	0.99 m ²
	Lin. coverage per row	9.81 lin. ft	3.02 lin. m
22 units			

Specifications per pallet ² (Only Available in Eastern USA and Canada)		Imperial	Metric
A 	Product dimension (L x W x H) A	6 1/2 x 13 x 2 3/8	165 x 330 x 60
	Product dimension (L x W x H) B	13 x 13 x 2 3/8	330 x 330 x 60
	Product dimension (L x W x H) C	19 1/2 x 13 x 2 3/8	495 x 330 x 60
44 units / pallet			
B 	Cubing	135.39 ft ²	12.58 m ²
	Approx. Weight HD ² Smooth	3 779 lbs	1 714 kg
	Number of rows	11	
44 units / pallet			
C 	Coverage per row	12.31 ft ²	1.14 m ²
	Lin. coverage per row	11.37 lin. ft	3.47 lin. m
33 units			

²New packaging HD² Smooth - Available after depletion of original packaging

MECHANICAL INSTALLATION²

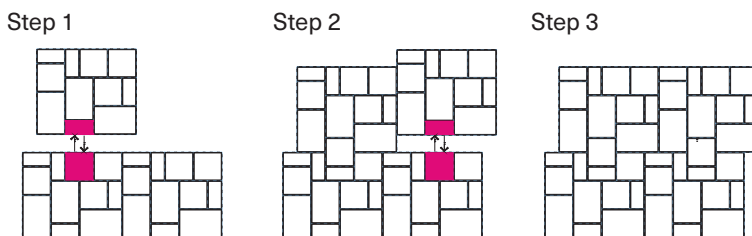

Clamp or Mechanical tool available for machine installation.
Check with your local Techo-Bloc representative for more information.

NOTES

See page 6 for icons description.

See page 16 for more information about applications.

See page 26 to 28 for more technical information. When used in a permeable pavement application, see page 93 to 102 for more technical information.

*For this application, it is recommended that this product be installed on a concrete base as designed by a local Engineer.

JOINT WIDTH: 3/32" (7 mm)
% OF SURFACE OPENING: 4.5%**
INFILTRATION RATE: 570 in./hr (14 475 mm/hr)

**For permeable application, the installation should be combined with Blu 6 x 13 in a modular pattern. A min. of 4.5% opening surface requires 75% of Blu 6 x 13 and 25% of Blu.

Pallet Overview

